



2024 PRODUCT GUIDE

# PURMO PLUS SERIES ELECTRIC RADIATORS







## PLUS SERIES ELECTRIC RADIATORS

# Unmatched Comfort, Unbeatable Simplicity.

Comfort shouldn't be complicated.

With the Plus Series electric radiators from Purmo, you get heat that feels just right—natural, consistent, and perfectly adjusted to your liking.

No gas. No plumbing. No maintenance or upkeep. No noisy fans or stuffy, hot air that breathes down your neck. No blowing dust. No temperature swings or cold draughts on your feet.

Just reliable, completely silent radiant heat that feels as natural as the sun on your skin.

Experience warmth the way it should be. Comfortable, consistent and uncomplicated.



## Benefits of Purmo Plus Radiators:

### Easy Installation

Takes less than 30 minutes per panel by an electrician or handyman.

### Oil-Filled & Electric

No need to run pipes throughout your house to a central boiler.

### No Maintenance or Upkeep Required

Unlike hydronic systems, Purmo radiators are entirely maintenance free.

### Independent Operation

You'll never have to run a central system to keep a single room warm.

### Precision Temperature Control

Highly-accurate thermostat keeps rooms at a precise temperature with no wasted energy.

### Family Safe

No blowing dust or allergens, and additional child safety modes to lower surface temperature.

### Central Wireless Control

Control via smartphone or home automation when paired with the Unisenza+ Gateway.

### Built to Last

Solid steel construction, with a 10 year warranty on the panel, and 2 years on the electronics.





## Radiant Heat, Redefined.

The feeling of sun on your skin...the warm glow of a campfire.

That's the comfort of radiant heat. Europeans have relied on central radiant heating to stay warm for decades.

But hydronic systems like these are expensive, difficult to install and reliant on gas.

Built on the same production line as hydronic panels by one of Europe's largest heating manufacturers, Purmo electric radiators deliver this exact same type of heat without the need for invasive pipes or central boilers.

## Silent Precision

Heat that's so consistent, silent and comfortable - you'll forget it's even turned on.

Thanks to a precision thermostat and high thermal mass, your rooms stay at the set temperature and no energy is wasted.

The fully-enclosed electric element means Purmo radiators operate in complete silence. There's no noisy fans, no creaking, crackling or popping.



## Strength Meets Style

Whether you're drawn to the classic radiator design of Yali or the streamlined, minimalism of Parada, there's a style to compliment your home.

Made in the U.K from robust, fully-recyclable steel and filled with non-toxic vegetable oil, they're built to last and designed to impress.

All backed by a 10-year warranty on the panel and 2 years on the electronics. Simple, sturdy, and stylish – that's our promise.

# Solutions for Every Space

With 20 different sizes - there's a Purmo radiator that's right for every space.

Start simple with one or two radiators, or fit out your whole home.

The choice is yours.

## Single Panel / H300

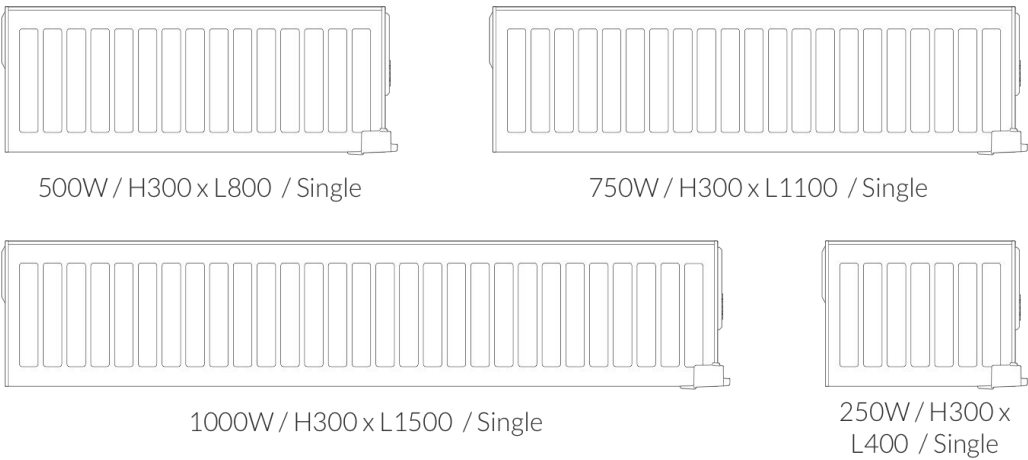

## Single Panel / H500

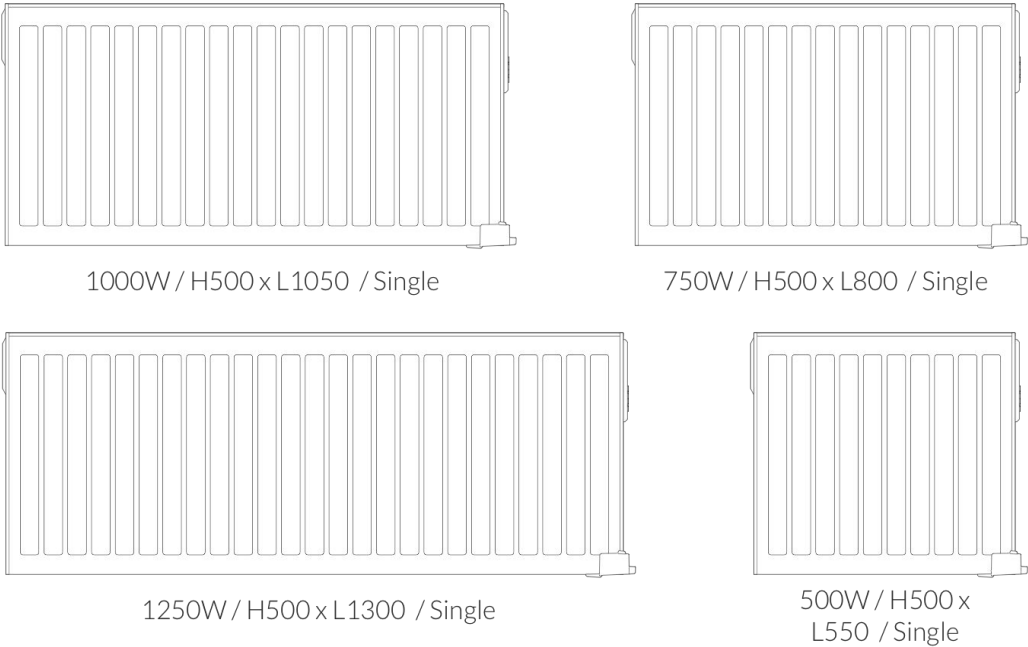

## Double Panel / H300

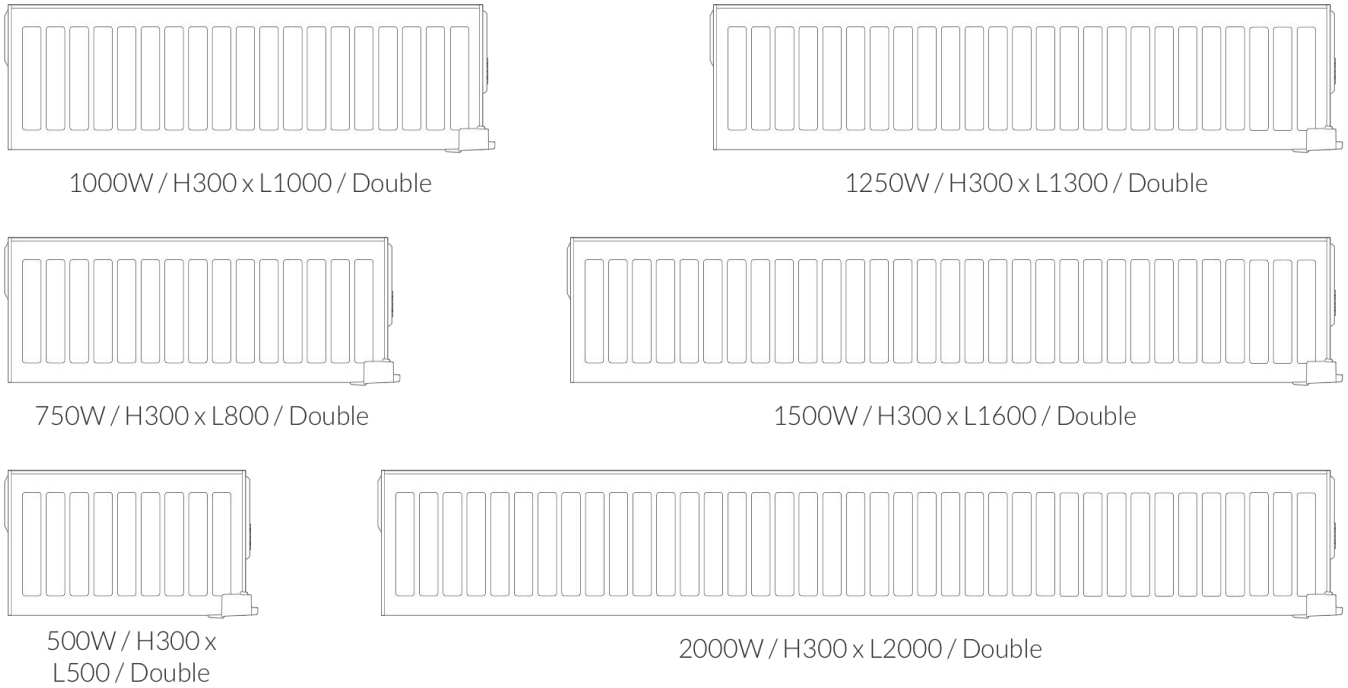

## Double Panel / H500

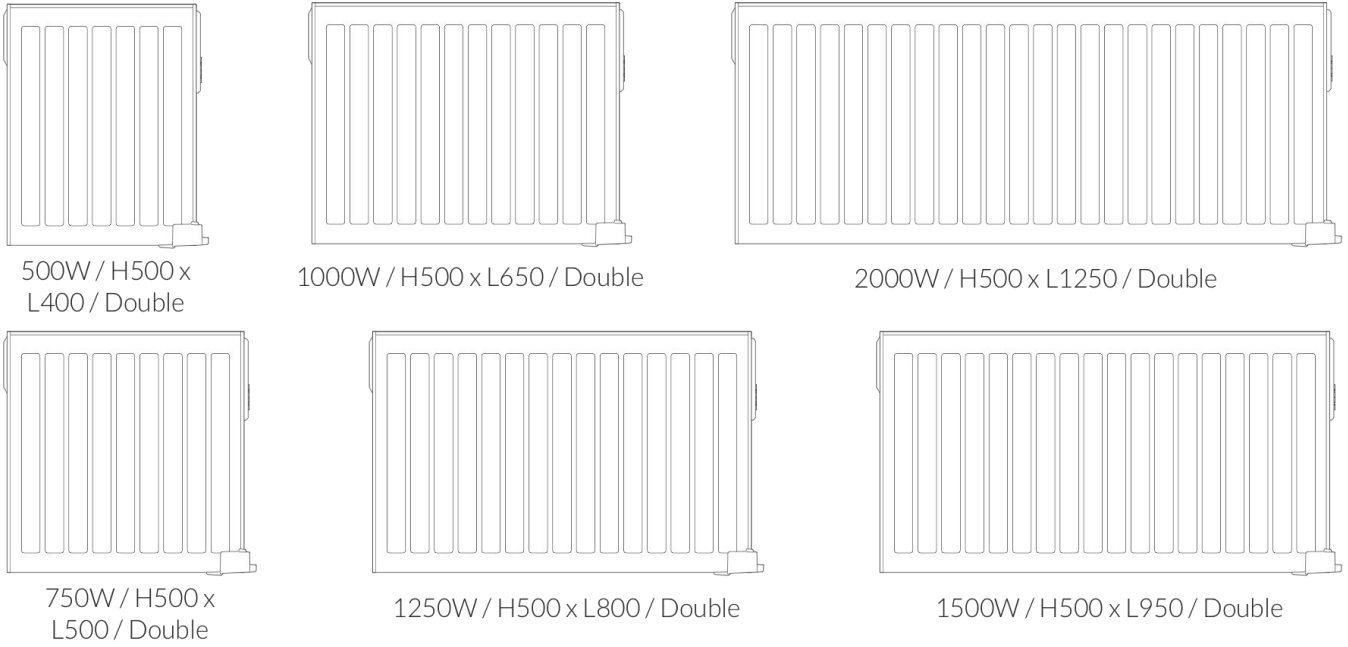





# Yali Plus Electric Radiator

## CLASSIC EUROPEAN STYLE

Yali Plus, the evolution of our iconic oil-filled electric radiator, blends elegance, intelligent features, and unparalleled build quality with a revamped control interface.

Retaining the original steel radiator body, sizing choices, and comforting radiant warmth, Yali Plus now boasts an expanded backlit screen, cutting-edge Zigbee 3.0 smart home capabilities, and flawless integration by smartphone app when paired with the Unisenza+ Smart Gateway.

## Yali Plus H300 Radiators



**300mm high panels** are low and long - perfect for placing along hallways or under windows and countertops

Model	SKU	Watts	Amps	Height (mm)	Length (mm)	Weight (kg)
Yali Plus 250W / H300 x L400 / Single	FE7110300401A4U0	500	1.1	300	400	7.7
Yali Plus 500W / H300 x L500 / Double	FE7210300501A4U0	500	2.2	300	500	12
Yali Plus 500W / H300 x L800 / Single	FE7110300801A4U0	750	2.2	300	800	11.4
Yali Plus 750W / H300 x L800 / Double	FE7210300801A4U0	750	3.3	300	800	16.9
Yali Plus 750W / H300 x L1100 / Single	FE7110301101A4U0	1000	3.3	300	1100	15.2
Yali Plus 1000W / H300 x L1000 / Double	FE7210301001A4U0	1000	4.3	300	1000	20.5
Yali Plus 1000W / H300 x L1500 / Single	FE7110301501A4U0	1250	4.3	300	1500	19
Yali Plus 1250W / H300 x L1300 / Double	FE7210301301A4U0	1250	5.4	300	1300	26.5
Yali Plus 1500W / H300 x L1600 / Double	FE7210301601A4U0	1500	6.5	300	1600	31.5
Yali Plus 2000W / H300 x L2000 / Double	FE7210302001A4U0	2000	8.7	300	2000	38.5

## Yali Plus H500 Radiators



**500mm high panels** are taller and less wide - ideal for rooms where wall space is at a premium

Model	SKU	Watts	Amps	Height (mm)	Length (mm)	Weight (kg)
Yali Plus 500W / H500 x L400 / Double	FE7210500401A4U0	500	2.2	500	400	14.6
Yali Plus 500W / H500 x L550 / Single	FE7110500551A4U0	500	2.2	500	550	11.7
Yali Plus 750W / H500 x L500 / Double	FE7210500501A4U0	750	3.3	500	500	17
Yali Plus 750W / H500 x L800 / Single	FE7110500801A4U0	750	3.3	500	800	16
Yali Plus 1000W / H500 x L650 / Double	FE7210500651A4U0	1000	4.3	500	650	21.5
Yali Plus 1000W / H500 x L1050 / Single	FE7110501051A4U0	1000	4.3	500	1050	20.8
Yali Plus 1250W / H500 x L800 / Double	FE7210500801A4U0	1250	5.4	500	800	24.6
Yali Plus 1250W / H500 x L1300 / Single	FE7110501301A4U0	1250	5.4	500	1300	24.9
Yali Plus 1500W / H500 x L950 / Double	FE7210500951A4U0	1500	6.5	500	950	31
Yali Plus 2000W / H500 x L1250 / Double	FE7210501251A4U0	2000	8.7	500	1250	38.6



# Parada Plus Electric Radiator

SLEEK, MINIMAL, MODERN

Parada Plus, the refined evolution of our sleek electric radiator. With its flat steel front, the Parada Plus retains its minimalist appeal while incorporating an enhanced backlit screen, cutting-edge Zigbee 3.0 smart home capabilities, and seamless integration with Unisenza+ app, Google Home, and Amazon Alexa via the Unisenza+ Smart Gateway.

Experience the perfect balance of radiant and convection heat, designed for freezing Scandinavian winters, in a contemporary and elegant package.

## Parada Plus H300 Radiators



**300mm high panels** are low and long - perfect for placing along hallways or under windows and countertops

Model	SKU	Watts	Amps	Height (mm)	Length (mm)	Weight (kg)
Parada Plus 250W / H300 x L400 / Single	FE4110300401A4U0	500	1.1	300	400	8.7
Parada Plus 500W / H300 x L500 / Double	FE4210300501A4U0	500	2.2	300	500	13.3
Parada Plus 500W / H300 x L800 / Single	FE4110300801A4U0	750	2.2	300	800	13.4
Parada Plus 750W / H300 x L800 / Double	FE4210300801A4U0	750	3.3	300	800	18.9
Parada Plus 750W / H300 x L1100 / Single	FE4110301101A4U0	1000	3.3	300	1100	18.0
Parada Plus 1000W / H300 x L1000 / Double	FE4210301001A4U0	1000	4.3	300	1000	23.0
Parada Plus 1000W / H300 x L1500 / Single	FE4110301501A4U0	1250	4.3	300	1500	22.8
Parada Plus 1250W / H300 x L1300 / Double	FE4210301301A4U0	1250	5.4	300	1300	29.8
Parada Plus 1500W / H300 x L1600 / Double	FE4210301601A4U0	1500	6.5	300	1600	35.6
Parada Plus 2000W / H300 x L2000 / Double	FE4210302001A4U0	2000	8.7	300	2000	43.6

## Parada Plus H500 Radiators



**500mm high panels** are taller and less wide - ideal for rooms where wall space is at a premium

Model	SKU	Watts	Amps	Height (mm)	Length (mm)	Weight (kg)
Parada Plus 500W / H500 x L400 / Double	FE4210500401A4U0	500	2.2	500	400	16.3
Parada Plus 500W / H500 x L550 / Single	FE4110500551A4U0	500	2.2	500	550	14.0
Parada Plus 750W / H500 x L500 / Double	FE4210500501A4U0	750	3.3	500	500	19.1
Parada Plus 750W / H500 x L800 / Single	FE4110500801A4U0	750	3.3	500	800	19.3
Parada Plus 1000W / H500 x L650 / Double	FE4210500651A4U0	1000	4.3	500	650	24.2
Parada Plus 1000W / H500 x L1050 / Single	FE4110501051A4U0	1000	4.3	500	1050	25.9
Parada Plus 1250W / H500 x L800 / Double	FE4210500801A4U0	1250	5.4	500	800	27.9
Parada Plus 1250W / H500 x L1300 / Single	FE4110501301A4U0	1250	5.4	500	1300	30.3
Parada Plus 1500W / H500 x L950 / Double	FE4210500951A4U0	1500	6.5	500	950	35.0
Parada Plus 2000W / H500 x L1250 / Double	FE4210501251A4U0	2000	8.7	500	1250	43.8



# Plus Series Specifications

Material	<ul style="list-style-type: none"><li>■ Made from cold rolled, fully recyclable steel of the highest quality.</li><li>■ Filled with non-toxic, biodegradable vegetable oil</li></ul>
Colour	<ul style="list-style-type: none"><li>■ Hard-wearing white epoxy paint (RAL 9016).</li></ul>
Child Safety	<ul style="list-style-type: none"><li>■ Control panel with child lock function</li><li>■ Max radiator surface temperature can be lowered to 75°C or 60°C (will result in reduction of maximum heat output).</li></ul>
Included in Package	<ul style="list-style-type: none"><li>■ Monclac wall brackets and screws for fixed installation</li></ul>
Panel Options	<ul style="list-style-type: none"><li>■ Single (11), Double (21)</li></ul>
Splash Rating	<ul style="list-style-type: none"><li>■ IP44 when installed with wallbox splash cover (required for compliance)</li></ul>
Warranty	<ul style="list-style-type: none"><li>■ 10 years warranty on radiator body</li><li>■ 2 years warranty on electronics</li></ul>
Thermostat Features	<ul style="list-style-type: none"><li>■ Advanced digital thermostat with precision temperature control.</li><li>■ Central control by smartphone when combined with Unisenza+ Smart Gateway and Purmo Unisenza App</li><li>■ Weekly program can be individually adjusted in each radiator.</li><li>■ Adaptive start with timer function.</li><li>■ Open window function.</li></ul>

## Optional Accessories



**Unisenza+ Zigbee 3.0 Smart Home Gateway**  
Connect the gateway to your Wi-Fi router and enjoy full central control of your radiators via the new Unisenza+ smartphone app, Google Home or Amazon Alexa. You can configure zones, set schedules and monitor your energy usage with the app.



**Radiator Hardwiring Kit**  
The Radiator Hardwiring Kit simplifies the process of professionally hardwiring radiators. An electrician mounts the wall box behind the radiator and wires it through the wall. It also features a splash guard that preserves the radiator's IP44 rating, and a replacement plug for connecting the radiator the wall box.



**90° Degree Adaptor**  
The 90° Adaptor allows the display to be rotated by 90 degrees on Yali & Parada radiators. This makes it possible to turn the display so that it faces forward, a handy accessory for installations near walls.

# Installation

- Installation of Plus Series electric radiators is simple.
- Two brackets are screwed into the wall. Bracket design varies based on the selected model. (FIGURE A)
  - For plaster walls, brackets should be screwed into a stud due to the weight of the radiators.
  - The radiator is placed onto the bracket feet. (FIGURE B)
  - The top clip is then clicked into place along the radiator top grill (FIGURE C) and tightened with an Allen key. (FIGURE D)
  - Brackets can be secured at any point along the length of the radiator, provided the radiator is appropriately balanced.

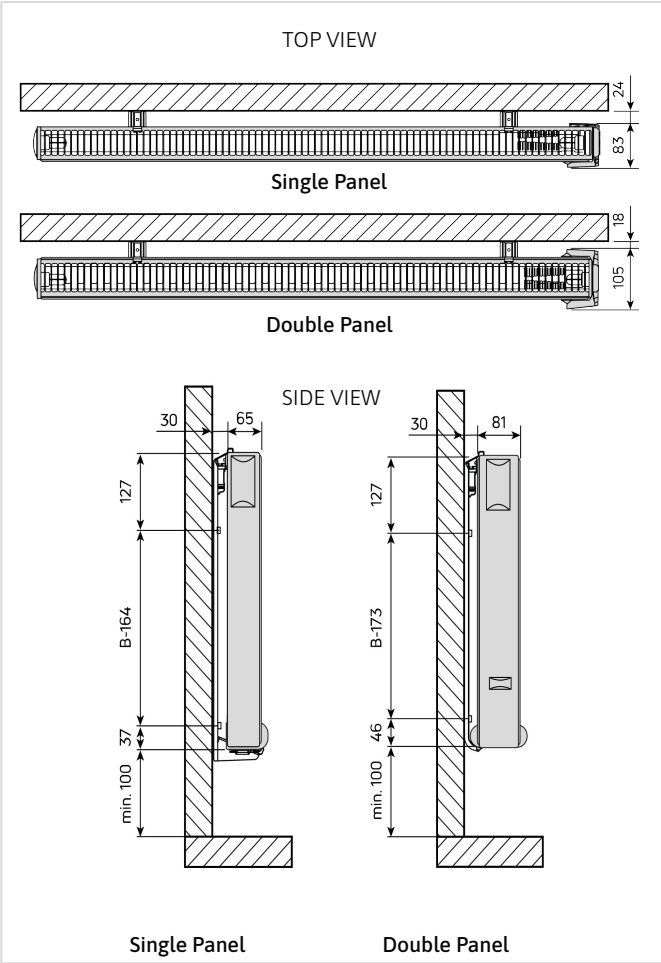
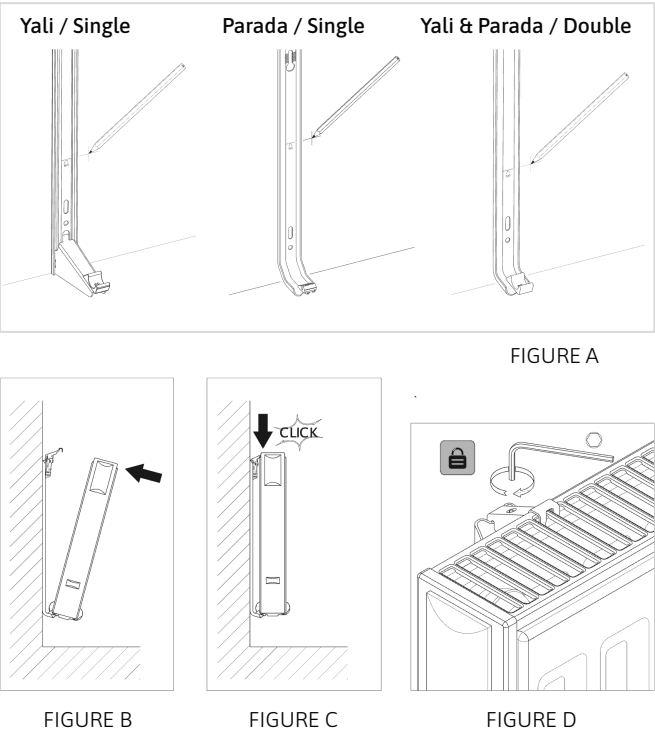

## Panel Configurations

Plus Series radiators are available in **double** and **single** panel configurations.

**Single Panel Radiators**  
These have a slim design (95mm depth from wall), due to having single oil-filled panel, and a convection plate at the back

They're great for areas where space it at a premium, such as hallways, bathrooms or under desks..

**Double Panel Radiators**  
These have a second oil-filled panel instead of a convection plate. They're 16mm thicker than single panel radiators (111mm depth from wall)

This allows you to fit more heating capacity in less wall space, ideal for rooms with more demanding heating needs.



# Our Mission

We're helping Australians make the switch to sustainable, electric heating - without sacrificing quality, comfort or style

By providing great products and friendly, old-fashioned service, we've been able to help thousands of Australians get off gas while staying wonderfully warm and cosy in winter over the past 23 years.

Our mission now is to accelerate Australia's move to an all-electric future. To do this, we're adopting forward-thinking technologies and approaches that allow us to deliver the friendly service and brilliant products we're known for to more people than ever.

# Our Products

Since 1999, Thermosoft Australia has been the exclusive Australian distributor for electric radiators and FINIMETAL towel rails from our European supplier, Purmo Group.

Our radiators and towel rails combine the unrivalled comfort and warmth of radiant heating with timeless European styling and exceptional build quality. All at significantly lower upfront cost than comparable gas hydronic systems.

Our original radiators were sold under the LVI brand. LVI, Lidköpings Värmeindustri was founded in Lidköping, Sweden in 1922. In 1970 the factory was expanded to include the manufacture of oil-filled electric radiators. It was around this time the first Yali products were born. By using the most durable materials available, Yali's timeless style set the standard for the entire industry in quality, design and performance.

LVI is now owned by Purmo Group, one of the world's leading manufacturers of heating products. Our electric radiators are made on the same production lines as regular hydronic radiators.

# Our Story

Themosoft Australia, formerly LVI Thermosoft, was founded in Perth by Bo Ramen in 1999, later moving to the beautiful Mornington Peninsula, Victoria. Upon Bo's retirement, the business was taken over in 2012 by electrician Stuart Wilson and his wife, Maya.

After moving to a larger showroom and warehouse in Frankston, Victoria - Thermosoft Australia is now able to deliver heating systems Australia-wide with the help of our network of agents and installers.

With the rapid rise of household solar and consumers seeking to transition away from gas, we're now busier than ever. With the help of new partners, we're overhauling our operations to allow us to help more Australians get off gas and upgrade their homes with luxurious, radiant heating.





